

**Cut out pattern of Kenmore/Whirlpool
Drip Tray and check fit on drip shelf**

**Actual Size. Select “Actual Size”
in Acrobat print options**

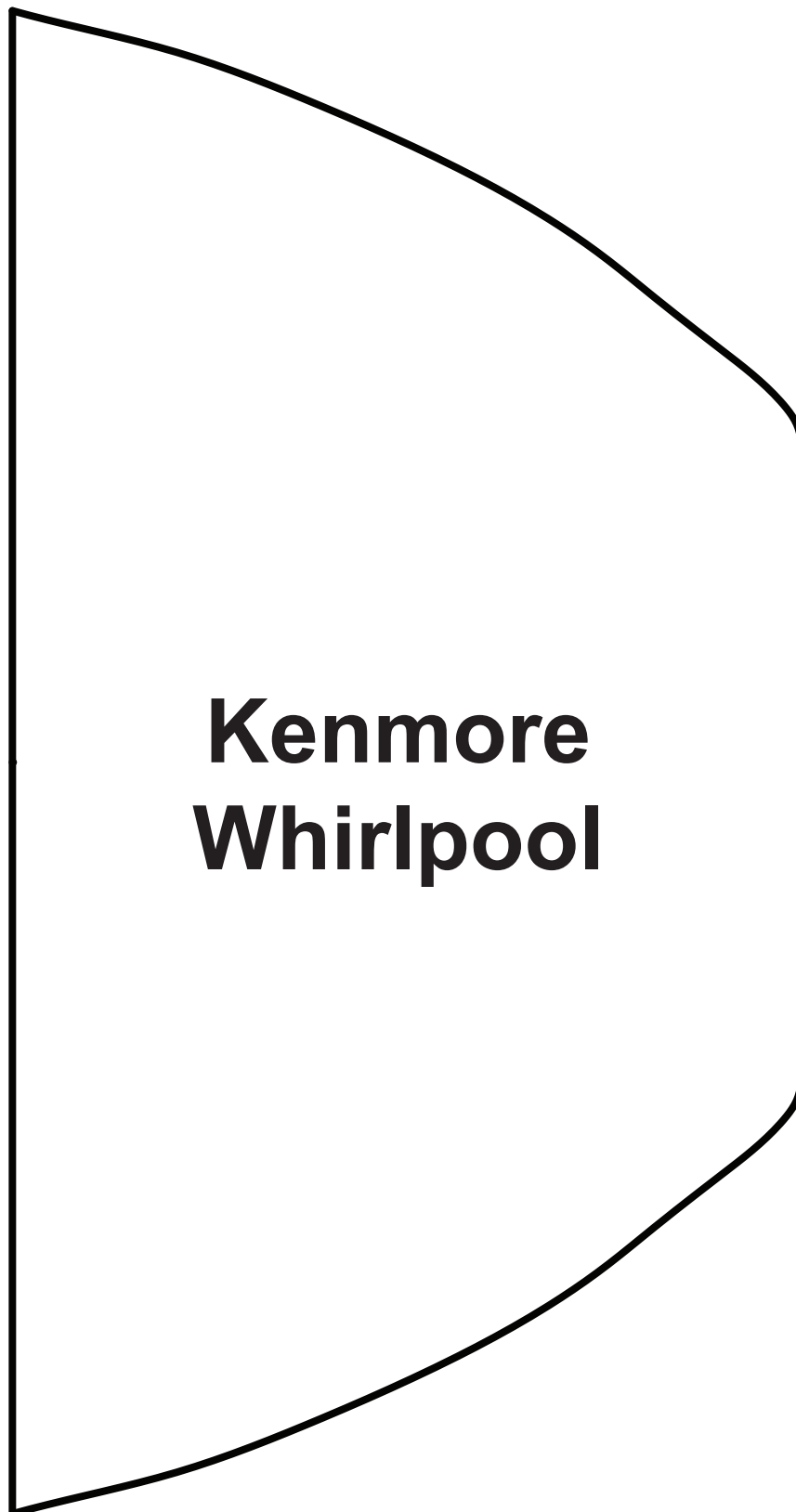

DRIP TRAY INSTALLATION INSTRUCTIONS:

HAND-WASH ONLY. DO NOT PUT IN DISHWASHER.

1. The Drip Tray system consists of a Drip Tray with either two or three magnets depending upon version of tray along with either 2 or 3 adhesive magnetic mounting plates. If you don't see the white metal adhesive disc attached to the magnet, then look inside the package to make sure they did not fall off. These are required to create a metal contact for the magnets to attach to.

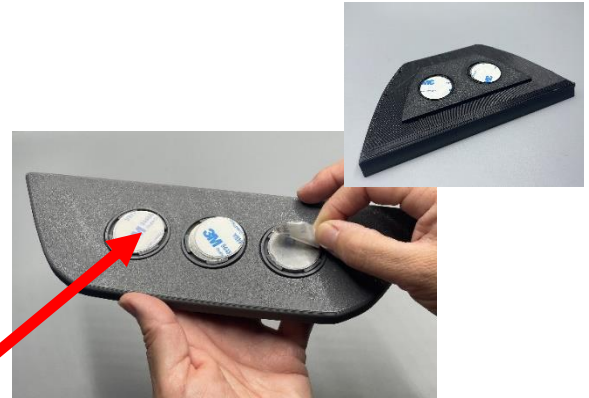

2. The adhesive mounting plates have a protective cover on both sides but only the side mounted top up in white has the adhesive side. Make sure the circular mounting plates are centered and concentric over the magnets. Some temporary tape is placed between the discs and the magnets to keep them in place and on center until they are attached to the drip shelf. Peel and remove the protective coating and ensure adhesive surface is on outer side. Also, make sure to clean your drip shelf very well using a cleaner like rubbing alcohol. Let the rubbing alcohol dry before placing the discs. You can remove the blueish protective cover on the other side after the disks before or after bonded to the shelf.



3. Center the Drip Tray to your refrigerator shelf and make sure the edge of Tray is lined up with edge of the plastic drip shelf edge and then press down firmly so that the disks stick to the shelf.
4. The adhesive mounting plates should be adhered firmly to your refrigerator shelf. If you have to re-position, these adhesive mounting plates can be removed if you can place a small flat head screwdriver under the edge and pull up firmly. But the plate will be mounted fairly strong. Place tape around the plate to protect from scratching your shelf.

